



K-PAD D-MOTION

Domus Line
design

LED luminaire for under cabinet lighting

Materials:

thermoplastic polymers, PMMA

Finishes:

aluminium, steel, black touch

Light source:

twin LED module

Connector:

Micro24

Wiring:

2000mm

Application type:

under cabinet, under shelf

Installation:

on surface

K-PAD D-MOTION is an aluminium luminaire just 8mm thick integrating a twin LED cluster (2700 – 4000 K) with diffused light projection and LGP (Light Guide Plate) diffuser that cancels the spot effect. **K-PAD D-MOTION** is available in two configurations, both supplied with two-pole power cable and Micro24 connector: **TWA (Tunable White) without sensor and WHC (White Changeable) SDM (Sensor Dimmer Master)** with static colour temperature sensor wired master, with on-off function and brightness dimmer for adjusting individual luminaires or all those connected to it.

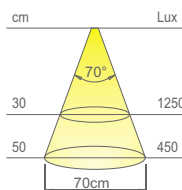
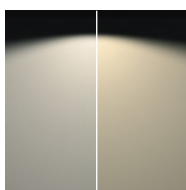

Colour appearance	Tunable White
Colour temperature	2700 - 4000 Kelvin
Luminous flux	200 lm
Luminous efficiency	40 lm/W
CRI	Ra ≥ 80



K-PAD TWA is a luminaire belonging to the new D-MOTION collection.

A PRODUCT AVAILABLE. VALIDATED TECHNICAL AND PHOTOMETRIC DATA.



K-PAD TWA SDM WHC

with touchless dimmer master switch



Code	Watt & Volt
13697_ _*/2	5W @ 24Vdc

CONVERTER NOT INCLUDED. TO BE ORDERED SEPARATELY.



Code	Finish*
10	aluminium
19	steel
46	black touch

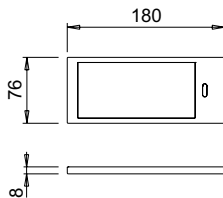

K-PAD TWA SDM WHC integrates an electronic infrared switch that turns on, turns off, selects the colour temperature and adjusts the luminous intensity of the luminaire and of all the appliances connected to it.



K-PAD TWA

without switch



Code	Watt & Volt
13697_ _*/1	5W @ 24Vdc

CONVERTER AND TWA SELECTOR NOT INCLUDED. TO BE ORDERED SEPARATELY.



Code	Finish*
10	aluminium
19	steel
46	black touch

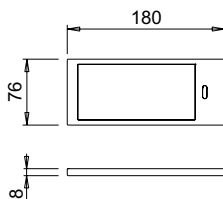

White Changeable (WHC) SDM (Sensor Dimmer Master) luminaires in the D-MOTION collection integrate a sensor for static colour temperature selection of the luminaire (2700 K or 4000 K) as well as on/off and brightness control functions.



Tunable White (TWA) luminaires of the D-MOTION collection allow the static or dynamic colour temperature selection (2700 - 4000 K) by a remote selector supplied separately.



SETS OF 2, 3, 4 OR 5 **K-PAD D-MOTION** AVAILABLE ON REQUEST WITH LED CONVERTER.

FINISHES



ALUMINIUM (code 10)



STEEL (code 19)



BLACK TOUCH (code 46)

For LED converters and accessories consult the **Domus Extra catalogue** also available on www.domusline.com.

