



IR 2.0 SD

Dimmable touchless switch



Code	Input	Output	Power	Connectors	Code	Finish
17599_ _	24Vdc	24Vdc	72W	Micro24	01	white
17600_ _	12-24Vdc	12-24Vdc	36-72W	Micro12-Micro24	03	black

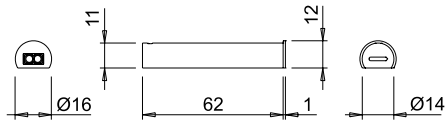

In dimmer switch mode, **IR 2.0 SD** turns the luminaire on and off and controls brightness simply by approaching a hand towards the sensor. A quick movement turns the luminaire on or off. A longer wave of the hand in front of the sensor controls brightness.

The **IR 2.0 SD** set-up can be changed from on/off dimmer switch to limit switch mode, by pressing the button on the back of the device.



on-off function

dimmer function



under-cabinet installation

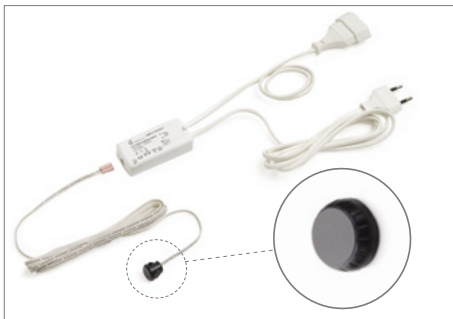
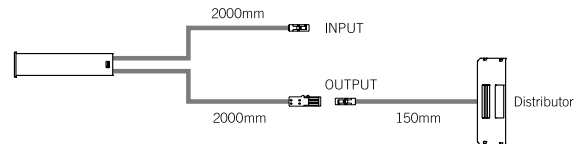

SIMPLY R1

Touchless switch - recessed sensor



Code	0834901
Input	220-240Vac
Output	220-240Vac
Power	250W
Module wiring	2000mm input cord with two-pole Europlug 500mm output cord with two-pole Europlug socket
Sensor wiring	2000mm cord with multi-pole connector

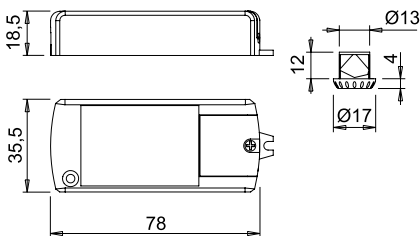

Consult the installation manual for more details on drilling holes for assembly.



on-off function

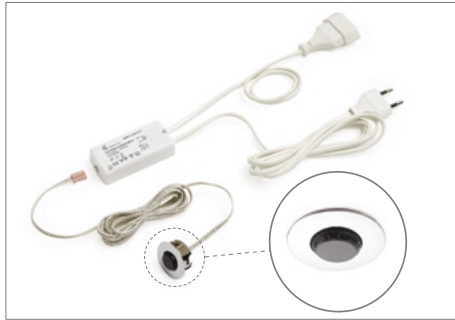

SIMPLY R2

CE EAC

touchless switch - recessed sensor with metal holder

Code	0834917B
Input	220-240Vac
Output	220-240Vac
Power	250W
Module wiring	2000mm input cord with two-pole Europlug 500mm output cord with two-pole Europlug socket
Sensor wiring	2000mm cord with multi-pole connector



satin nickel

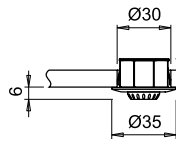
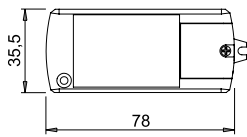

230V



Consult the installation manual for more details on drilling holes for assembly.



on-off function

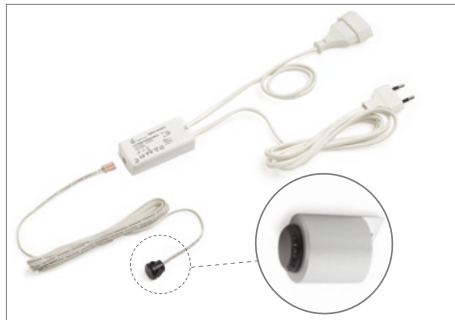

SIMPLY SP1

CE EAC

touchless switch - surface sensor with metal holder

Code	0834905B3
Input	220-240Vac
Output	220-240Vac
Power	250W
Module wiring	2000mm input cord with two-pole Europlug 500mm output cord with two-pole Europlug socket
Sensor wiring	2000mm cord with multi-pole connector



aluminium

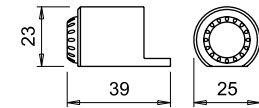
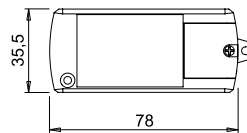
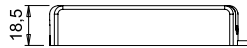

230V



on-off function



SIMPLY SP2

CE EAC

touchless switch - surface sensor with metal holder

Code	0834917B1
Input	220-240Vac
Output	220-240Vac
Power	250W
Module wiring	2000mm input cord with two-pole Europlug 500mm output cord with two-pole Europlug socket
Sensor wiring	2000mm cord with multi-pole connector



satin nickel

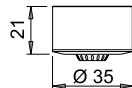
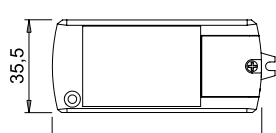

230V



on-off function