



ORBIT 24

Domus Line
design

Adjustable LED spotlight

Materials:

thermoplastic polymers, PMMA

Finishes:

chrome plated, satin nickel, steel,
black touch, white matt

Light source:

SMD LED module

Connector:

Micro24

Wiring:

2000mm

Application type:

universal

Installation:

recessed and on surface

Patented

ORBIT PLUS 24 is an adjustable spotlight designed for recessed installation in Ø68 mm holes, ideal for all furnishing compositions where a beam needs to be directed. The fixing system, with two steel clamping springs, is easy to install without the use of tools. **ORBIT PLUS 24** incorporates a high-performance SMD LED module with no-dot effect technology, ensuring a uniform projection beam without the dot effect.

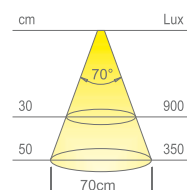
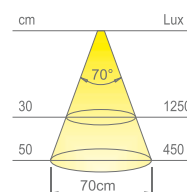
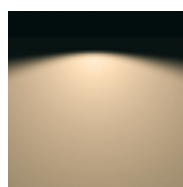
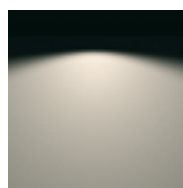

Colour appearance	natural white
Colour temperature	4300 K
Luminous flux	390 lm
Luminous efficiency	130 lm/W
CRI	Ra ≥ 80

Colour appearance	super warm white
Colour temperature	2700 K
Luminous flux	360 lm
Luminous efficiency	120 lm/W
CRI	Ra ≥ 80



ORBIT PLUS 24



Code	Watt & Volt	Light colour
	3W @ 24Vdc	natural white
	3W @ 24Vdc	super warm white

Code	Finish
09	chrome plated
17	satin nickel
19	steel
46	black touch
54	white matt

LED CONVERTER NOT INCLUDED. TO BE ORDERED SEPARATELY.

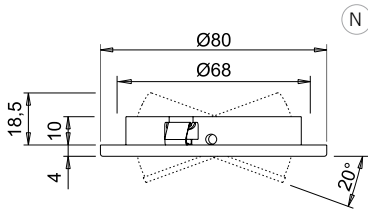

(N) This drawing shows the spotlight's overall dimensions. See installation manual for more details.



ORBIT PLUS 24 features the innovative **Plug&Play system (patented)**, for easy disconnection of the power cord from the spotlight.



Spacers are available on request for surface installation:

Code	Finish
20127_ _	see finishes codes

FINISHES



CHROME PLATED (code 09)



SATIN NICKEL (code 17)



STEEL (code 19)



BLACK TOUCH (code 46)



WHITE MATT (code 54)

For LED converters and accessories consult the **Domus Extra catalogue** also available on www.domusline.com.

